

# Frame Round / Wall Frame Round Maxi



220-240V, 50/60Hz

|  |  |
|--|--|
| <p>Frame Round/Wall</p> <p>Frame Round Maxi</p>  |  |
| <p>Max 16 A</p> <ul style="list-style-type: none"> <li>0,5 - 1,0 mm<sup>2</sup> → 8 mm</li> <li>1,5 - 2,5 mm<sup>2</sup> → 12 mm</li> </ul>  |  |
|  | <p>Frame Sensor</p>  |
| <p><b>NO:</b> Skru av strømmen før montering.<br/> <b>DK:</b> Sluk for strømmen inden montering.<br/> <b>SE:</b> Stäng av strømmen innan montering.<br/> <b>EN:</b> Turn off power before installing.<br/> <b>FR:</b> Couper le courant avant l'installation.<br/> <b>NL:</b> Stroom uitschakelen voor u het toestel installeert.<br/> <b>DE:</b> Vor Installationsarbeiten den Strom abschalten.<br/> <b>FI:</b> Sammuta virta ennen kytkemistä</p> | <p><b>NO:</b> Kan kun installeres og vedlikeholdes av en registrert installasjonsvirksomhet.<br/> <b>DK:</b> Må kun installeres og vedligeholdes af uddannet elektriker.<br/> <b>SE:</b> Skall installeras och underhållas av behörig elektriker.<br/> <b>EN:</b> Only to be installed and maintained by an authorized electrician.<br/> <b>FR:</b> Doit être installé et maintenu par un électricien qualifié.<br/> <b>NL:</b> Mag alleen geïnstalleerd en onderhouden worden door een bevoegde electricien.<br/> <b>DE:</b> Dieses Produkt darf nur durch autorisiertes Personal (z.B. Elektro-Installateur) angeschlossen, in Betrieb genommen und gewartet werden.<br/> <b>FI:</b> Asentaa ja huoltaa saa vain valtuutettu sähköasentaja</p> |

Rev: 20.09.2024

**NORWAY**  
SG Armaturen AS

Skytterheia 25  
N-4790 Lillesand

Tel: +47 37 50 03 00  
firmapost@sg-as.no  
www.sg-as.no

**SWEDEN**  
SG Armaturen AB  
Tel: +46 31 81 71 10  
info@sg-ab.se  
www.sg-ab.se

**FINLAND**  
SG Armaturen Oy  
Tel: +358 02 07 30 39 60  
info@sg-oy.fi  
www.sg-oy.fi

**DENMARK**  
SG Armaturen A/S  
Tel: +45 70 70 72 13  
info@sg-as.dk  
www.sg-as.dk

**UNITED KINGDOM**  
SG Lighting LTD  
Tel: +47 37 50 03 00  
info@sglighting.co.uk  
www.sglighting.co.uk

**FRANCE**  
SG Lighting SA/NV  
Tel: +33(0) 4 94 93 00 00  
info.france@sglighting.fr  
www.sglighting.net

**BENELUX**  
SG Lighting SA/NV  
Tel: +32(0) 15 20 72 71  
info.benelux@sglighting.net  
www.sglighting.net

**GERMANY**  
SG Leuchten GmbH  
Tel: +49 40 23 99 44 59  
info@sg-leuchten.de  
www.sg-leuchten.de

**INTERNATIONAL**  
SG Lighting Co Ltd.  
Tel: +86 769 88 49 20 88  
cindy@sgdgc.com  
www.sg-as.com

# Dipswitch

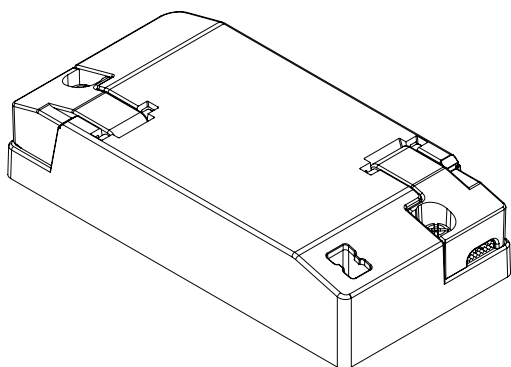

Standard

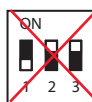
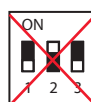

|           |             |      |     |     |     |     |
|-----------|-------------|------|-----|-----|-----|-----|
| <b>mA</b> | <b>200</b>  | 250  | 300 | 350 | 400 | 450 |
| <b>Im</b> | <b>100%</b> | 125% | -   | -   | -   | -   |

Frame Round/Wall

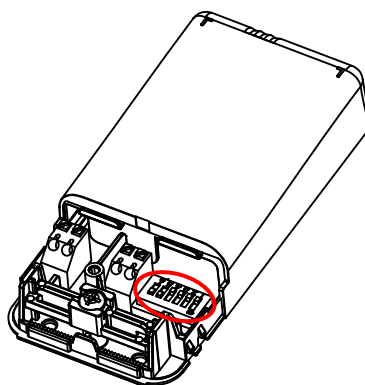
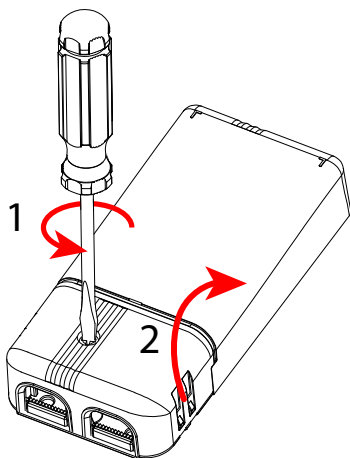

|           |     |     |     |     |     |     |
|-----------|-----|-----|-----|-----|-----|-----|
| <b>mA</b> | 250 | 300 | 350 | 400 | 450 | 500 |
| <b>Im</b> | 45% | 55% | 64% | 73% | 82% | 91% |

Frame Round Maxi

Standard



|           |             |      |      |                |                    |                      |
|-----------|-------------|------|------|----------------|--------------------|----------------------|
| <b>mA</b> | <b>550</b>  | 600  | 650  | <del>700</del> | <del>750-900</del> | <del>12/24/28V</del> |
| <b>Im</b> | <b>100%</b> | 109% | 118% | <del>-</del>   | <del>-</del>       | <del>-</del>         |

# Sensor Dim

## Motion and daylight

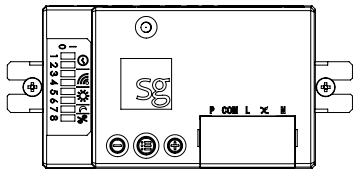

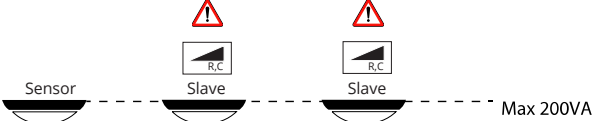

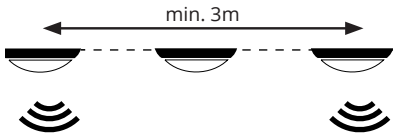

**No Com**

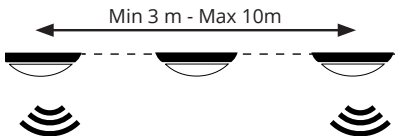

**With Com**



Group max 6 pcs/com



**Master/Master**

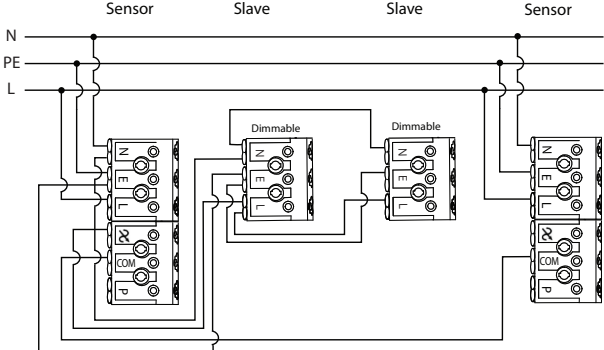

**Push**

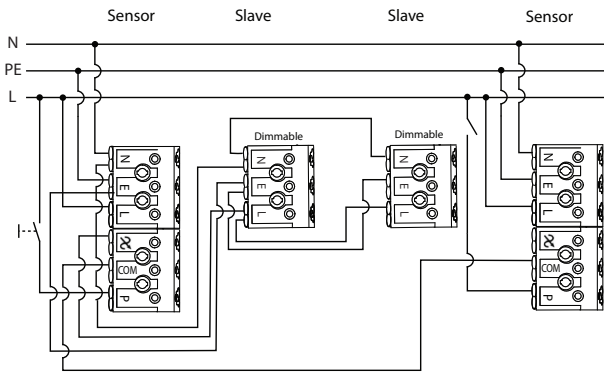



NO: Impulsbryter (valgfritt)  
 DK: Impulsafbryder (valgfritt)  
 SE: Impulsbrytare (valgfritt)  
 EN: Push button (optional)  
 FR: Bouton-poussoir (optionnel)  
 NL: Drukknop (optioneel)  
 DE: Druckknopf (optional)  
 FI: Painonappi (valinnainen)

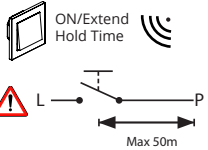

|           |            |   |   |
|-----------|------------|---|---|
|           |            | 1 | 2 |
| Hold time | 10 minutes | 1 | 1 |
|           | 5 minutes  | 0 | 1 |
|           | 1 minute   | 1 | 0 |
|           | 5 seconds  | 0 | 0 |

|                    |        |   |   |
|--------------------|--------|---|---|
|                    |        | 3 | 4 |
| Motion sensitivity | High   | 1 | 1 |
|                    | Medium | 0 | 1 |
|                    | Low    | 1 | 0 |
|                    | Off    | 0 | 0 |

|                      |        |   |   |
|----------------------|--------|---|---|
|                      |        | 5 | 6 |
| Daylight sensitivity | Low    | 1 | 1 |
|                      | Medium | 0 | 1 |
|                      | High   | 1 | 0 |
|                      | Off    | 0 | 0 |

|              |     |   |
|--------------|-----|---|
|              |     | 7 |
| Midnight cut | On  | 1 |
|              | Off | 0 |

|             |     |   |
|-------------|-----|---|
|             |     | 8 |
| Basic light | On  | 1 |
|             | Off | 0 |

**NORWAY**  
SG Armaturen AS

Skytterheia 25  
N-4790 Lillesand

Tel: +47 37 50 03 00  
firmapost@sg-as.no  
www.sg-as.no

**SWEDEN**

SG Armaturen AB  
Tel: +46 31 81 71 10  
info@sg-ab.se  
www.sg-ab.se

**FINLAND**

SG Armaturen Oy  
info@sg-oy.fi  
www.sg-oy.fi

**DENMARK**

SG Armaturen A/S  
Tel: +45 70 70 72 13  
info@sg-as.dk  
www.sg-as.dk

**UNITED KINGDOM**

SG Lighting LTD  
Tel: +47 37 50 03 00  
info@sglighting.co.uk  
www.sglighting.co.uk

**FRANCE**

SG Lighting SA/NV  
Tel: +33(0) 4 94 93 00 00  
info.france@sglighting.fr  
www.sglighting.net

**BENELUX**

SG Lighting SA/NV  
Tel: +32(0) 15 20 72 71  
info.benelux@sglighting.net  
www.sglighting.net

**GERMANY**

SG Leuchten GmbH  
Tel: +49 40 23 99 44 59  
info@sg-leuchten.de  
www.sg-leuchten.de

**INTERNATIONAL**

SG Lighting Co Ltd.  
Tel: +86 769 88 49 20 88  
cindy@sgdgc.com  
www.sg-as.com

### Hold time

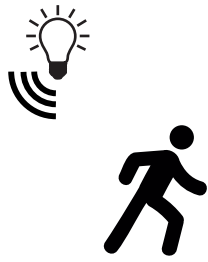

|        |   |   |
|--------|---|---|
|        | 1 | 2 |
| 10 min | 1 | 1 |
| 5 min  | 0 | 1 |
| 1 min  | 1 | 0 |
| 5 sec  | 0 | 0 |



### Motion sensitivity

|                    |   |   |
|--------------------|---|---|
| <b>Sensitivity</b> | 3 | 4 |
| High               | 1 | 1 |
| Medium             | 0 | 1 |
| Low                | 1 | 0 |
| Off                | 0 | 0 |

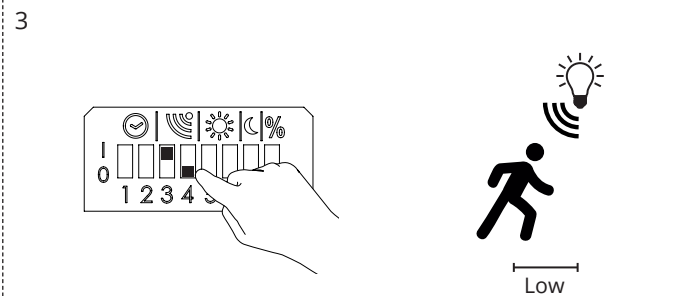
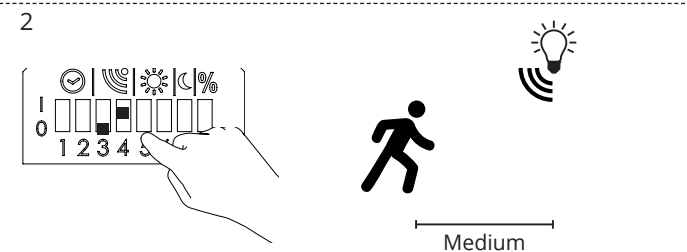
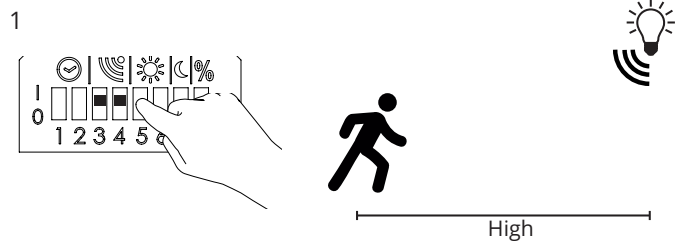
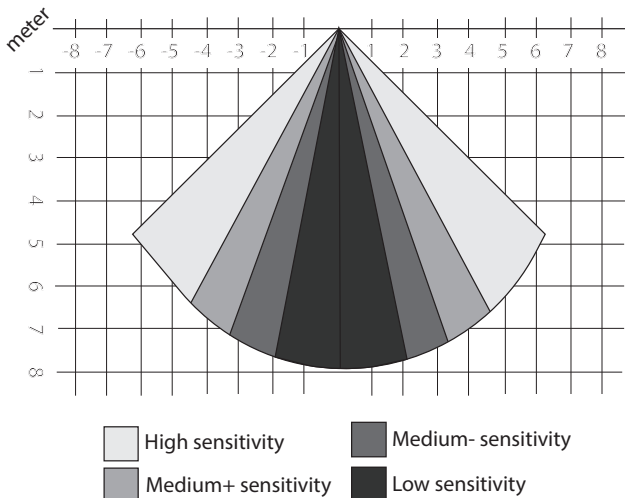

### Daylight sensitivity

|                    |   |   |
|--------------------|---|---|
| <b>Sensitivity</b> | 5 | 6 |
| Low                | 1 | 1 |
| Medium             | 0 | 1 |
| High               | 1 | 0 |
| Off                | 0 | 0 |

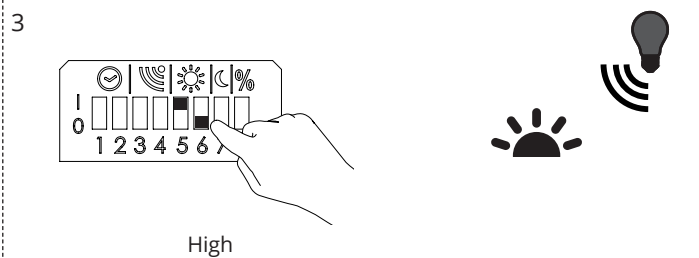
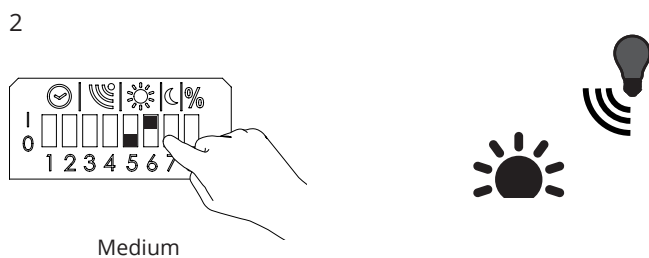
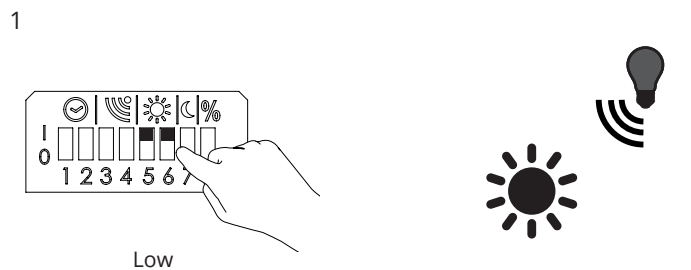

### Midnight cut

~00:00 - 05:00 AM

~00:00 - 05:00 AM

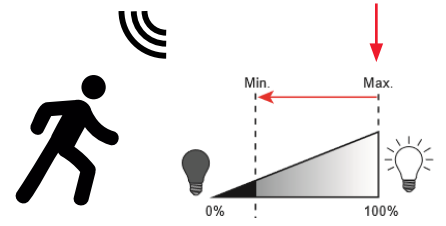
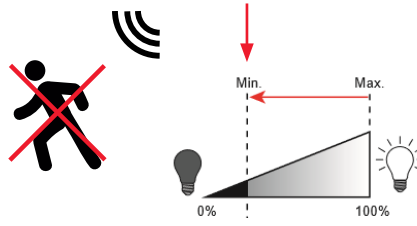
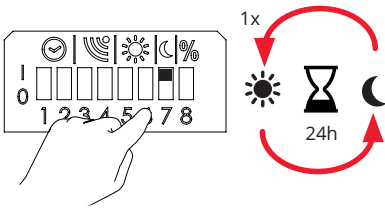

### Light levels - Basic light and max light

1

2

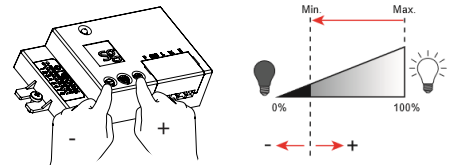
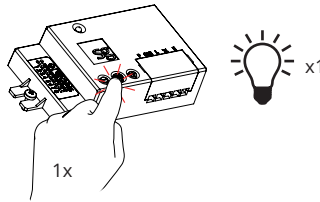
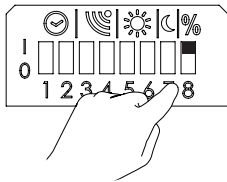

Basic light

3

4

5

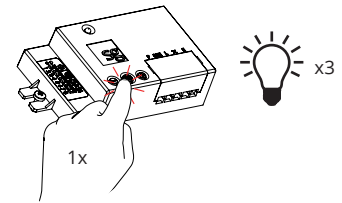
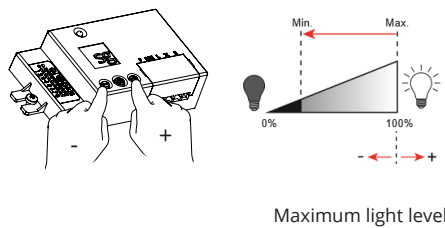
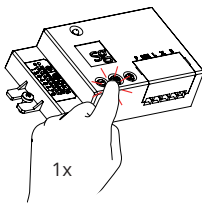

### Light levels - Midnight cut

1

2

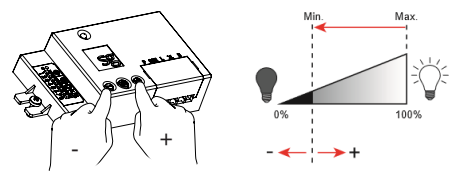
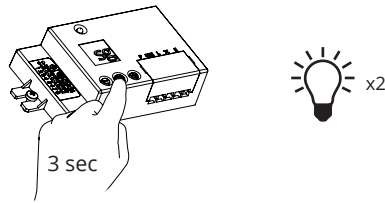
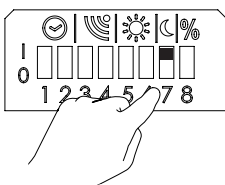

Minimum midnight cut

3

4

5

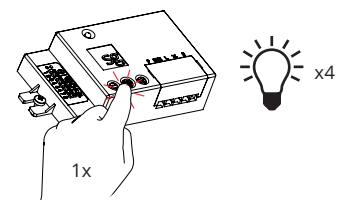
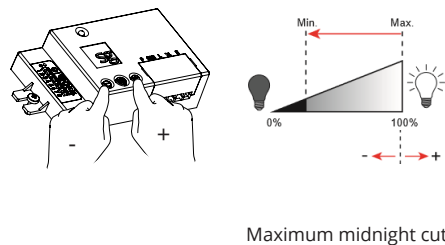
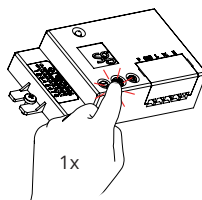

Maximum midnight cut

# Basic Motion and daylight sensor

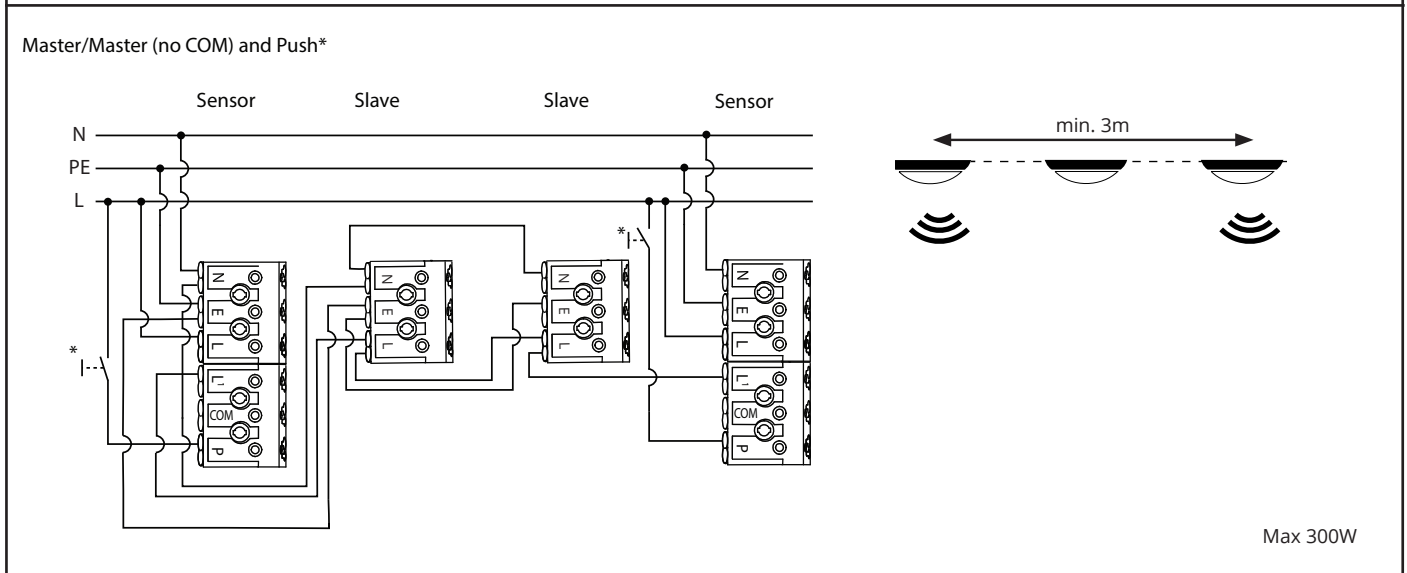
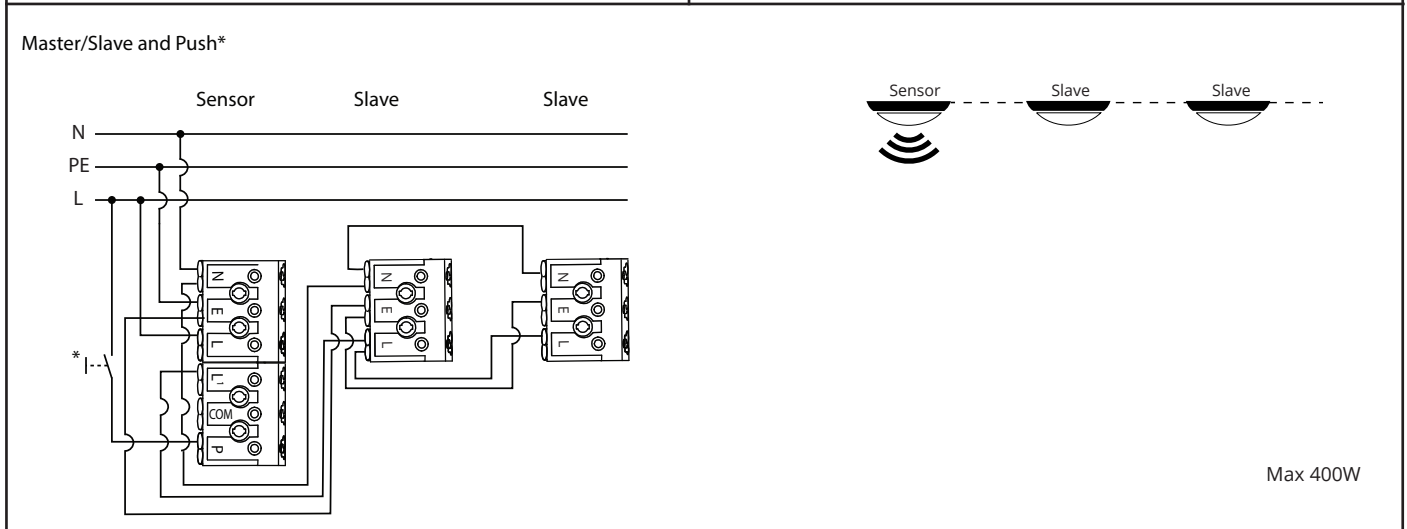
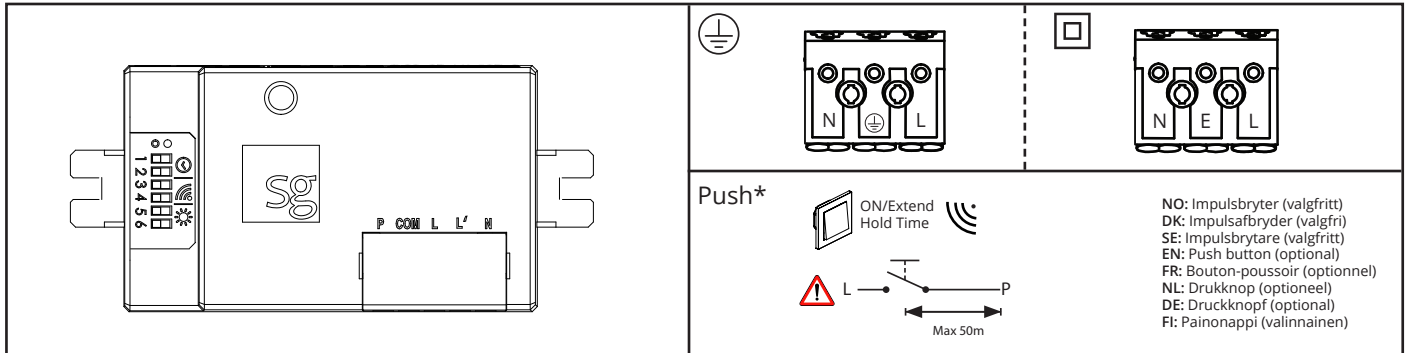

**NORWAY**  
 SG Armaturen AS

Skytterheia 25  
 N-4790 Lillesand

Tel: +47 37 50 03 00  
 firmapost@sg-as.no  
 www.sg-as.no

**SWEDEN**

SG Armaturen AB  
 Tel: +46 31 81 71 10  
 info@sg-ab.se  
 www.sg-ab.se

**FINLAND**

SG Armaturen Oy  
 info@sg-oy.fi  
 www.sg-oy.fi

**DENMARK**

SG Armaturen A/S  
 Tel: +45 70 70 72 13  
 info@sg-as.dk  
 www.sg-as.dk

**UNITED KINGDOM**

SG Lighting LTD  
 Tel: +47 37 50 03 00  
 info@sglighting.co.uk  
 www.sglighting.co.uk

**FRANCE**

SG Lighting SA/NV  
 Tel: +33(0) 4 94 93 00 00  
 info.france@sglighting.fr  
 www.sglighting.net

**BENELUX**

SG Lighting SA/NV  
 Tel: +32(0) 15 20 72 71  
 info.benelux@sglighting.net  
 www.sglighting.net

**GERMANY**

SG Leuchten GmbH  
 Tel: +49 40 23 99 44 59  
 info@sg-leuchten.de  
 www.sg-leuchten.de

**INTERNATIONAL**

SG Lighting Co Ltd.  
 Tel: +86 769 88 49 20 88  
 cindy@sgdgc.com  
 www.sg-as.com

Master/Master (with COM) and Push\*

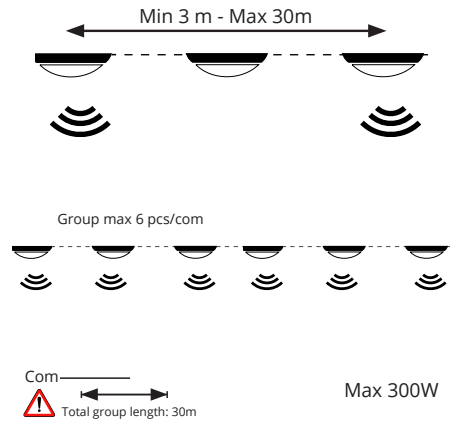
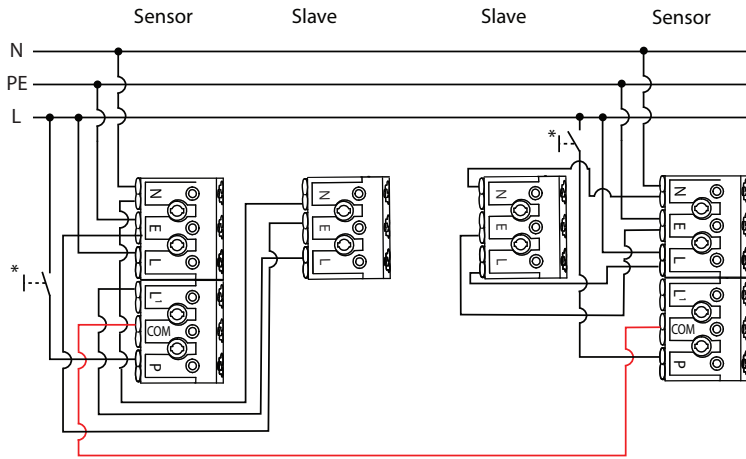

|           |            |   |   |
|-----------|------------|---|---|
| Hold time |            | 1 | 2 |
|           | 30 minutes | 1 | 1 |
|           | 5 minutes  | 0 | 1 |
|           | 1 minute   | 1 | 0 |
|           | 5 seconds  | 0 | 0 |

|                    |          |   |   |
|--------------------|----------|---|---|
| Motion sensitivity |          | 3 | 4 |
|                    | High     | 1 | 1 |
|                    | Medium + | 0 | 1 |
|                    | Medium - | 1 | 0 |
|                    | Low      | 0 | 0 |

|                      |          |   |   |
|----------------------|----------|---|---|
| Daylight sensitivity |          | 5 | 6 |
|                      | High     | 1 | 1 |
|                      | Medium + | 0 | 1 |
|                      | Medium - | 1 | 0 |
|                      | Low      | 0 | 0 |

Hold time

|        |   |   |
|--------|---|---|
|        | 1 | 2 |
| 30 min | 1 | 1 |
| 5 min  | 0 | 1 |
| 1 min  | 1 | 0 |
| 5 sec  | 0 | 0 |

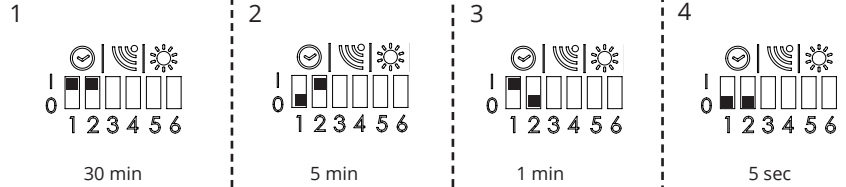

Motion sensitivity

|             |   |   |
|-------------|---|---|
| Sensitivity | 3 | 4 |
| High        | 1 | 1 |
| Medium +    | 0 | 1 |
| Medium -    | 1 | 0 |
| Low         | 0 | 0 |

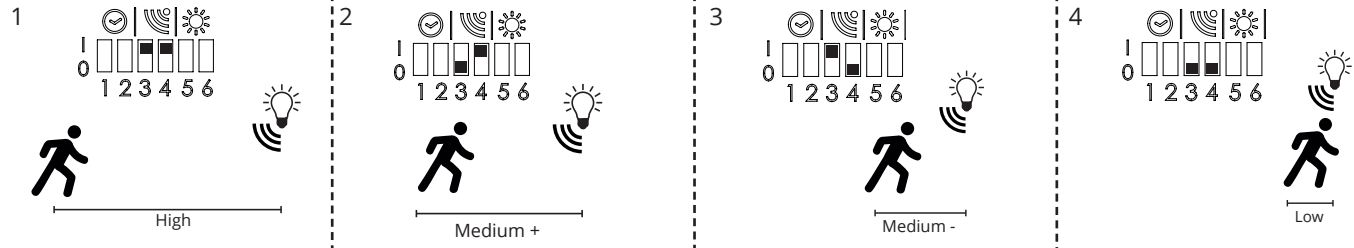
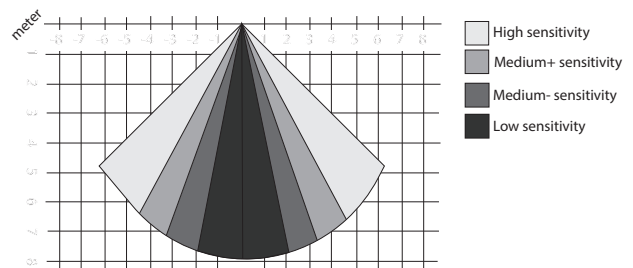

Daylight sensitivity

|             |   |   |
|-------------|---|---|
| Sensitivity | 5 | 6 |
| Low         | 1 | 1 |
| Medium -    | 0 | 1 |
| Medium +    | 1 | 0 |
| High        | 0 | 0 |

